

MODEL	G	L1	L2	♂
M-BSL-M5	M5	4	18	8
M-BSL-01	R1/8	6	24	12
M-BSL-02	R1/4	7.5	30	15
M-BSL-03	R3/8	9	39	19
M-BSL-04	R1/2	10.5	46	22
M-BSL-06	R3/4	11	55	27
M-BSL-10	R1	14	70	34
M-BSL-12	R1 1/4	15	78	46
M-BSL-14	R1 1/2	15	83	52

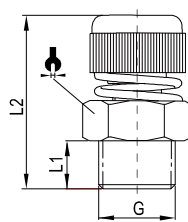

MODEL	G	L1	L2min	L2max	♂
M-ISD-01	R1/8	6	21	23	12
M-ISD-02	R1/4	7.5	25.5	28	15
M-ISD-03	R3/8	9	30.5	33	19
M-ISD-04	R1/2	10.5	34.5	37.5	22
M-ISD-06	R3/4	11	45	50	27
M-ISD-10	R1	14	52	57	34

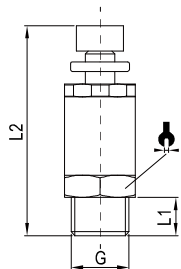

MODEL	G	L1	L2min	L2max	♂
M-BESL-01	R1/8	6	36.5	43	12
M-BESL-02	R1/4	7.5	36.5	48	14
M-BESL-03	R3/8	9	45	58	17
M-BESL-04	R1/2	10.5	57	74	24

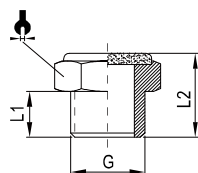

MODEL	G	L1	L2	♂
M-BSLM-M5	M5	4	8	8
M-BSLM-01	R1/8	6	11.5	12
M-BSLM-02	R1/4	7.5	14	15
M-BSLM-03	R3/8	9	16	19
M-BSLM-04	R1/2	10.5	18	22
M-BSLM-06	R3/4	12	21	27
M-BSLM-10	R1	14	23	34

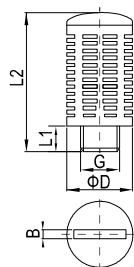

MODEL	G	ΦD	L1	L2	B
M-PSL-01	R1/8	16	7	32	2.2
M-PSL-02	R1/4	20	8	42	2.2
M-PSL-03	R3/8	24	10	55.5	2.2
M-PSL-04	R1/2	24	10	56	2.2
M-PSL-06	R3/4	48	17	134	2.5
M-PSL-10	R1	48	17	134	2.5

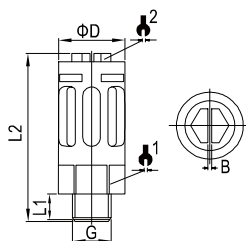

MODEL	G	ΦD	L1	L2	B	♂	♂
M-PSU-M5	M5	8.5	5	18	0.9	14	8
M-PSU-01	R1/8	16	6.5	40	1.3	18	12
M-PSU-02	R1/4	21	10	65	1.3	22	14
M-PSU-03	R3/8	25	12.5	85	1.5	26	18
M-PSU-04	R1/2	30	14	94		33	
M-PSU-06	R3/4	45	16	100		33	
M-PSU-10	R1	45	17	100			

辅助元件

接头 - 调速阀